

Non-Submersible Pumps

Jet Pumps - Convertible

Pro Series



NRTL/C
CSA 108
UL 778

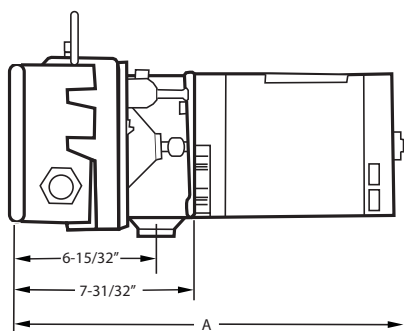
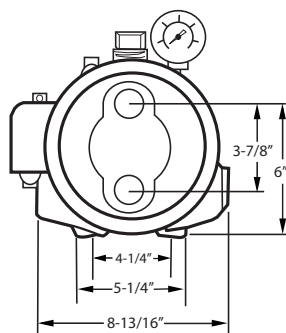

Pro Series

Features:

- Heavy-duty cast iron case and bronze impeller ensure optimum durability.
- Thermoplastic diffuser is molded for efficiency and dependability.
- Screw-in injector for easy conversion from shallow to deep well installation.
- Shaft coupling designed for easy removal of pump motor.
- Mechanical shaft seal ensures leakproof fit and continuous water lubrication.
- High service factor 56C-frame motor for maximum performance.
- Hardware kit allows for versatility of installation and includes pressure gauge, plugs, shallow well injector, and bypass plug.
- Adjustable pressure switch is factory-installed at 30/50 psi.
- Connections:
1-1/4" NPT suction
1" NPT discharge
1" NPT drive line
- Maximum temperature of 140 °F/60 °C

Dimensions		
Model	HP	A
FP05CI-C	1/2	18.65"
FP07CI-C	3/4	19.15"
FP1CI-C	1	19.65"

Note: Dimensions will vary according to motor manufacturer.

Non-Submersible Pumps

Jet Pumps - Convertible

Pro Series Ordering Information (See pgs. 2-3 for model number explanation)

Pro Convertible Jet Pumps								
Model	HP	Suction x Discharge	Voltage	Pump Unit		Deep Well Injector		
				Order No.	Wt.	Suction Lift	Order No.	Wt.
FP05CI-C	1/2	1-1/4" x 1"	115/230	91140005	48	30 - 60 ft	147E1120	7
						50 - 100 ft	147E0915	7
FP07CI-C	3/4	1-1/4" x 1"	115/230	91140007	51	30 - 60 ft	147E1023	7
						50 - 100 ft	147E1118	7
FP1CI-C	1	1-1/4" x 1"	115/230	91140010	53	30 - 60 ft	147E1125	7
						50 - 100 ft	147E1120	7

- Notes:**
1. Order deep well injector separately.
 2. Minimum inside well diameter requirement of 4" for deep well injectors.
 3. Weight in pounds.

Optional Injector for High Head Performance		
Injector Ordering No.	Model	HP
18-1278-03-R	FP1CI-C	1

Pressure Gauge	
Ordering No.	Pressure Reading
9193-4018	0-100 PSI

Required for Deep Well Installations:



Parallel Pipe Injectors